

NUTRI NINJA™

BL480NZ

OWNER'S GUIDE



IMPORTANT SAFETY INSTRUCTIONS

For Household Use Only

WHEN USING ELECTRICAL APPLIANCES, BASIC SAFETY PRECAUTIONS SHOULD ALWAYS BE FOLLOWED, INCLUDING THE FOLLOWING:

READ ALL INSTRUCTIONS BEFORE USING YOUR NUTRI NINJA™ WITH AUTO IQ™.

IMPORTANT:

This appliance is not intended for use by persons with reduced physical, sensory or mental capabilities, or lack of experience and knowledge, unless they have been given supervision or instruction concerning use of the appliance by a person responsible for their safety.

Children shall not use or play with this appliance. Close supervision is necessary to keep appliance and cord out of reach of children during use.

⚠ WARNING:

The blades are not affixed to the unit. They are removable and very sharp. Handle with care!

⚠ CAUTION:

In order to avoid a hazard due to inadvertent resetting of the thermal cut-out, this appliance must not be supplied through an external switching device, such as a timer, or connected to a circuit that is regularly switched on and off by the utility.

WARNING:

TO REDUCE THE RISK OF FIRE, ELECTRIC SHOCK OR INJURY:

1. To protect against electrical shock, do not submerge the appliance or allow the power cord to come into contact with water or any other liquid.
2. **DO NOT** allow young children to operate the appliance or use as a toy. Close supervision is necessary when any appliance is used near children.
3. Never leave an appliance unattended when in use.
4. Turn the appliance off and remove the power cord from the electrical outlet when not in use, before assembling or disassembling parts, accessing parts that move while in use and before cleaning. To unplug, grasp the plug and pull from the electrical outlet. Never pull from the power cord.
5. **DO NOT** abuse the power cord. Never carry the appliance by the power cord or yank it to disconnect from electrical outlet; instead, grasp the plug and pull to disconnect.
6. **DO NOT** use with damaged cord or plug. Contact Customer Service or Service Center for the repair or replacement of the line cord.
7. **DO NOT USE** if the appliance is not working, has been dropped, dropped into water, damaged or left outdoors.
8. **NO SERVICEABLE PARTS.** Incorrect re-assembly or repair can cause a risk of electrical shock or injury to persons when the appliance is used. Contact Customer Service or Service Center for the repair or replacement under the warranty agreement.
9. If the supply cord is damaged, it must be replaced by the manufacturer, its service agent or similarly qualified persons in order to avoid a hazard.

10. **DO NOT** let the power cord hang over the edge of table or counter or touch hot surfaces such as the stove.
11. Always use the appliance on a dry, level surface.
12. Keep hands, hair, clothing, as well as utensils out of container while processing or blending to reduce the risk of severe injury to persons or damage to the appliance. A scraper may be used but only when the appliance is not running.
13. **CAUTION: The blades are not affixed to the unit. They are removable and extremely sharp. When handling the blade assembly, do not hold the blades but rather always hold by the base of the blade assembly. Blades are sharp. Handle carefully!**
14. Avoid contact with moving parts.
15. **DO NOT** attempt to sharpen blades.
16. **DO NOT** use the appliance if blade assembly is bent or damaged.
17. To reduce the risk of injury, never attempt to place the Pro Extractor Blades™ assembly onto the motor base without first assembling the blade assembly to the Nutri Ninja™ Cup.
18. **DO NOT** operate this appliance on or near any hot surfaces (such as gas or electric burner or in a heated oven).
19. The use of attachments or accessories including canning jars, not recommended by the manufacturer may result in fire, electric shock or personal injury.
20. **DO NOT** remove any container from the motor base while the appliance is in operation. Always unplug the unit when not in use.
21. To reduce the risk of injury, **NEVER** operate the appliance without the blade assembly in place; **DO NOT** try to defeat the interlock mechanism; make sure that the attachment is properly installed before operating the appliance.
22. **CAUTION: DO NOT PROCESS HOT FOODS OR HOT LIQUIDS.** Allow hot ingredients to cool before processing.
23. Extreme caution must be used when moving an appliance containing hot food, water or other liquids.
24. **DO NOT** expose containers to extreme temperature changes.
25. **CAUTION: DO NOT process dry ingredients without adding liquid to the cup. This product is not intended for dry blending.**
26. **DO NOT** overfill. Do not exceed Max Fill line.
27. **DO NOT** operate the appliance empty.
28. If the appliance overheats, a thermal switch will become activated and shut off the motor. To reset, unplug the appliance and let it cool down for approximately 30 minutes before using again.
29. To reduce the risk of burns, always allow the appliance to cool before taking off parts and before cleaning.
30. Max ON time is 1 minute under 1000W load. If the appliance overheats, a thermal switch will become activated and shut off the motor. To reset, unplug the appliance and let it cool down for approximately 30 minutes before using again.
31. **THIS PRODUCT IS INTENDED FOR HOUSEHOLD USE ONLY.** Do not use this appliance for anything other than its intended use. Do not use outdoors.
32. Appliance accessories are not intended to be used in the microwave as it may result in damage to the accessories.

⚠ WARNING: Extension cords are not recommended for use with this product.

SAVE THESE INSTRUCTIONS

This appliance complies with the WEEE-Directive 2012/19/EU on the disposal of electrical and electronic equipment (WEEE).



This marking indicates that this product should not be disposed with other household wastes throughout the EU. To prevent possible harm to the environment or human health from uncontrolled waste disposal, recycle it responsibly to promote the sustainable reuse of material sources. To return your used device, please use the return and collection systems or contact the retailer where this product was purchased. They can take this product for environmental safe recycling.

This appliance complies with the European directives for electromagnetic compatibility (EMC) 2004/108/EC and its revisions, as well as Low Voltage Directive (LVD) 2006/95/EC and its revisions.

THIS BOOK COVERS MODEL NUMBERS:

BL480NZ 70

TECHNICAL SPECIFICATIONS

Voltage: 220-240V~, 50/60Hz

Power: 1000 Watts

Cup Capacity:

900 ml

650 ml

500 ml

Euro-Pro, Nutri Ninja, AUTO-iQ, Sip & Seal, Pro Extractor Blades and Ninja are trademarks of Euro-Pro Operating LLC.



Z854



TUV017304EA



Contents

**Thank you for
purchasing the
Nutri Ninja™
with AUTO-iQ™**

Getting to Know Your <i>Nutri Ninja™ with AUTO-iQ™</i>	6
Before First Use	8
Use	9
Suggested Uses	10
Care & Maintenance	11
Troubleshooting Guide	12
Replacement Parts	12
Warranty & Registration	13



Getting To Know Your Nutri Ninja™ with AUTO-iQ™

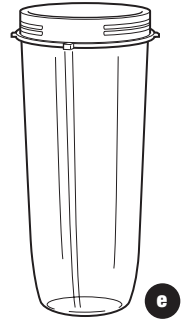
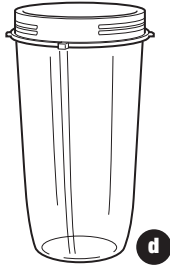
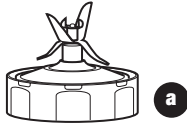

- a** Pro Extractor Blades™ Assembly
- b** Sip & Seal™ Lid (x3)
- c** Small 500 ml Nutri Ninja™ Cup
- d** Regular 650 ml Nutri Ninja™ Cup

- e** Jumbo Multi Serve 900 ml Nutri Ninja™ Cup
- f** Motor Base
- g** Power Cord (not shown)

Welcome to the Ninja® AUTO-iQ™ Experience! The Nutri Ninja™ with AUTO-iQ™ features pre-programmed settings that take the guesswork out of drink and meal making. These programs are timed to deliver consistent, delicious results that finish on their own so all you have to do is press a button and enjoy!

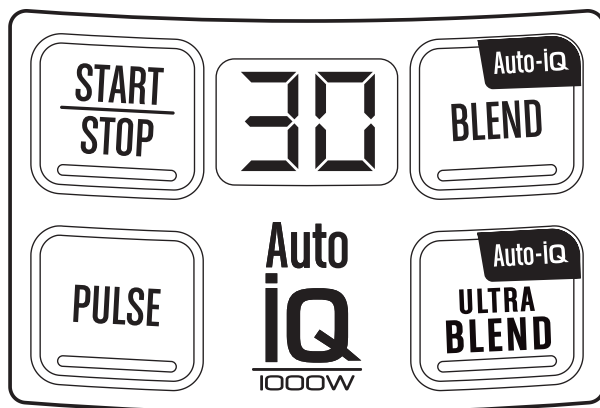

FEATURES:

- **Nutrient & Vitamin Extraction**
- **1000 Watt Motor**
- **User Interface:**

START | STOP

Press once to start continuous running, press again to stop
Timer counts up by seconds, up to 60 seconds

PULSE

Runs only while pressed down. Short presses make short pulses.
Timer counts up by seconds as long as pressed down

AUTO-iQ™ BLEND

Pulses and blends fresh or softer ingredients to create smooth consistent results. Timer counts down.

AUTO-iQ™ ULTRA BLEND

Pulses and blends frozen, fibrous or hard ingredients to create smooth consistent results. Timer counts down.

- **Personalized, healthy drinks and juices**
- **Sip & Seal™ lids for drinks on the go**
- **Nutri Ninja™ Cups, BPA free**
- **Cord storage**

Before First Use

PLEASE KEEP THESE IMPORTANT SAFEGUARDS IN MIND WHEN USING THE APPLIANCE:

- ⚠ **IMPORTANT:** Attachments are interchangeable.
- ⚠ **CAUTION: Blades are sharp! Use extreme caution when handling the blade assemblies. Always hold them by the base of the blade assembly.**
- ⚠ **IMPORTANT:** Never run the appliance empty.
- ⚠ **CAUTION: DO NOT PROCESS HOT FOODS OR HOT LIQUIDS.**
- ⚠ **CAUTION:** Never attempt to remove the cup while the appliance is still running.
- ⚠ **WARNING:** Never leave the appliance unattended while in use.

- 1 Remove all packaging material and labels from the appliance.
- 2 Wash the lids, cups and blade assembly in warm, soapy water with a soft cloth. **Use caution when washing the blade assembly as the blades are very sharp.**
- 3 Rinse and dry thoroughly.
- 4 Cups, lids and blade assembly are all dishwasher safe. It is recommended that the lids and attachments be placed on the top rack. Ensure that the blade assembly is removed from the cups before placing in the dishwasher.
- 5 Wipe the motor base clean with a damp cloth.

Use

ASSEMBLY

USE

REMOVAL

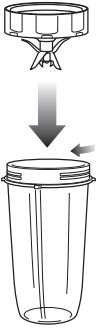

Fig. 1

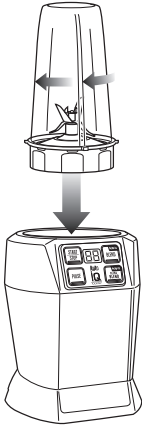

Fig. 2

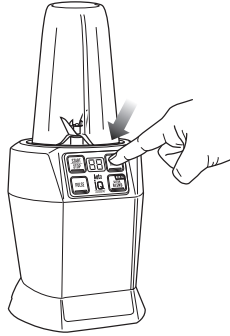

Fig. 3



Fig. 4

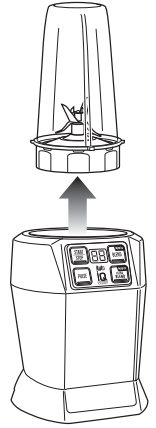

Fig. 5

▲ IMPORTANT: Place the motor base on a clean, dry, level surface such as a counter or table top.

1 Make sure that the motor base is plugged in for use. **No lights will turn on.**

2 Add ingredients to the cup.

NOTE: Do not overfill! to avoid spilling, do not add ingredients past the "MAX" fill line.

3 Place the blade assembly onto the cup and twist it on tightly until you have a good seal. **(Fig. 1)**

4 Turn the cup upside down and place it onto the motor base, aligning the tabs on the cup with the motor base. Turn it clockwise, until you feel it click into place. The Timer light will illuminate. **(Fig. 2)**

5 Press one of the buttons to activate. **(Fig. 3)**

NOTE: When using the AUTO-iQ™ presets, the unit will operate using pulses, pauses and continuous runs. The pauses allow the contents of the cup to settle. When the timer reaches "0", it will stop by itself.

6 To remove the cup, ensure that the motor has stopped running. Then turn the cup anticlockwise **(Fig. 4)** and pull straight up to remove. **(Fig. 5)**

7 Turn the cup upright and remove the blade assembly by twisting the blade assembly anticlockwise. Be sure to store the blade assembly attached to an empty cup when not in use.

8 Twist the Sip & Seal™ lid onto the cup to enjoy your drink on the go. Press flip top cap firmly into the opening to get the best seal. The flip top cap locks open when pressed backward.

9 Make sure that the motor base is unplugged when not in use.

10 To remove the motor base unit, tip the unit forward from the rear to easily disengage the suction cups.

Suggested Uses

PURPOSE / FUNCTION	SUGGESTED CUP	TYPE OF FOOD
Chopping / Pulsing	500 ml 650 ml	Salsa Leafy Herbs
Mixing	650 ml 900 ml	Batters Dips
Sauces	650 ml 900 ml	Vinaigrettes Salad Dressings Simple Sauces
Frozen Blending	500 ml 650 ml 900 ml	Ice Frozen Fruit Ice Cream
Nutrient Juices/Smoothies	500 ml 650 ml 900 ml	Fruits Vegetables Leafy Greens

⚠ CAUTION: DO NOT process dry ingredients without adding liquid to the cup. This product is not intended for dry blending.

FILLING YOUR Nutri Ninja™

Start with your Fresh Fruit or Veggies. Then add any Nuts, Seeds or Powder followed by any liquids like Juice or Milk. More liquid can help to integrate powder. Then add your Frozen Fruit and Ice. Remember to securely tighten the blade and don't overfill the cups. (Fig. 6)

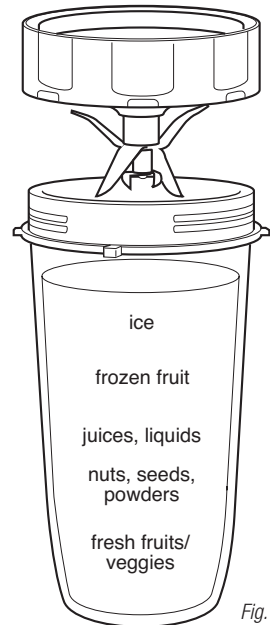

Fig. 6

Care & Maintenance

HOW TO CLEAN

⚠ CAUTION: Make sure that the motor base is unplugged from the power source before inserting or removing any attachment and before cleaning.

⚠ CAUTION: DO NOT immerse the motor base into water or any other liquid.

- 1 Separate/remove all parts from each other.
- 2 Clean the motor base with a damp cloth and wipe dry.
- 3 Place cups in the dishwasher. Place the lids and attachments on the top rack. **Use caution when handling the blade assemblies as the blades are very sharp.**

NOTE: You may also wash the cups by filling the cup to the Max fill line with warm water and a drop of dish washing detergent, placing the blade assembly on the cup and pulsing a few times. Do not fill the cup more than Max fill line with water because it will overflow. Once clean, remove the cup from the motor base. Rinse the cup, attachment and lid under running water. Allow all the parts to dry before storing.

If the appliance needs servicing, please call customer service at 0800 002 999 or 1800 890 840.

HOW TO STORE

- 1 Store the Nutri Ninja™ with AUTO-iQ™ upright. Secure the power cord underneath the base by wrapping the cord around the cord wrap. Do not place anything on top. Store the cups and the rest of the attachments along side the appliance where they will not be damaged and won't cause a hazard.

RESETTING THE MOTOR THERMOSTAT

The Nutri Ninja™ with AUTO-iQ™ features a unique safety system which prevents damage to the unit's motor and drive system should you inadvertently overload your appliance. If the appliance is being overloaded, the motor will stop. To reset the appliance, follow the resetting procedure below:

- 1 Unplug the appliance from the electrical outlet.
- 2 Remove and empty the cup and ensure that no food is jamming the cutting blades.
- 3 Allow the appliance to cool for approximately 30 minutes.
- 4 Re-install the cup onto the base and re-plug the appliance into the electrical outlet.
- 5 Proceed to use the appliance as before while making sure not to exceed the recommended maximum capacities.

Troubleshooting Guide

PROBLEMS	POSSIBLE REASONS & SOLUTIONS
Unit doesn't turn on	<ul style="list-style-type: none">• Make sure the unit is plugged in• Insert and rotate cup clockwise in the base until it "clicks". Display should turn on.
Unit doesn't turn off	<ul style="list-style-type: none">• Remove cup from base by rotating cup anticlockwise and lifting out. Display should turn off. Unplug the power cord from the outlet.
Lid/blade assembly hard to assemble	<ul style="list-style-type: none">• Set the cup on a level surface. Place the lid or blade assembly on the top of the cup and align the threads so that the lid/blades sit flat on the cup. Twist clockwise so that the lid/blades evenly align to the cup until you have a tight seal.
Food is not evenly chopped	<ul style="list-style-type: none">• For best results when chopping, make sure all ingredients are as dry as possible. Cut pieces down to even sizes, and reduce the amount of food in the cup. Use very short pulses by quickly pressing the "PULSE" button.
Doesn't mix well, food gets stuck.	<ul style="list-style-type: none">• Using the AUTO-iQ™ programs is the easiest way to achieve great results. The pulses and pauses allow the food to settle towards the blade. If food is routinely getting stuck adding some liquid will usually help.• When packing the cups, start with fresh items, then powders/nuts. Add liquids, and finally frozen items or ice.
Unit moves on counter while blending	<ul style="list-style-type: none">• Make sure the surface as well as the feet of the unit are clean and dry.
Unit is difficult to remove from counter for storage	<ul style="list-style-type: none">• Tip unit forward from the back to easily disengage the suction feet.

ONE (1) YEAR LIMITED REPLACEMENT WARRANTY STATEMENT

If your product becomes defective due to faulty material or workmanship within a period of 1 year from the date of purchase, we warrant to do the following:

- **For New Zealand Consumers:** We will replace the product with a new product, free of charge, or repair the product at our cost, at our discretion.
- **For Australian Consumers:** Our goods come with guarantees that cannot be excluded under the Australian Consumer Law. You are entitled to a replacement or refund for a major failure and for compensation for any other reasonably foreseeable loss or damage. You are also entitled to have the goods repaired or replaced if the goods fail to be of acceptable quality and the failure does not amount to a major failure.

Your warranty is subject to the following conditions:

- **DO NOT** operate the appliance with a damaged plug or cord, or if the unit has been dropped, damaged or dropped in water. To avoid the risk of electric shock, do not disassemble or attempt to repair the appliance on your own. If the supply cord is damaged, **it must be replaced by a qualified electrician in order to avoid a hazard.** Incorrect re-assembly or repair can cause a risk of electrical shock or injury to persons when the appliance is used.
- The product has not been misused, abused, neglected, altered, modified or repaired by anyone.
- The product has been subjected to fair wear and tear.
- The product has not been used for trade, professional or hire purposes.
- The product has not sustained damage through foreign objects, substances or accident.

Your warranty does not cover:

- Components that are subject to natural wear and tear caused by normal use in accordance with operating instructions.
- Unauthorised/improper maintenance/handling or overload is excluded from this warranty.
- For guarantee claims you will need to submit a proof of purchase in the form of a valid receipt that displays date and place of purchase.

This warranty does not replace but is in addition to your statutory rights.

This warranty does not apply to accessories supplied with the product.

This warranty applies only to the original purchaser and may not be transferred.

Replacement products will be covered by the limited warranty for the balance of the warranty period from the date of the original purchase.

Please note:

Only defective product or parts returned to place of purchase will be replaced under this warranty.

New Zealand Contact:

Brand Developers Limited
Level 1, 519-521 Lake Rd, Takapuna,
North Shore City 0622, Auckland, New Zealand
Private Bag 93204, Parnell, Auckland 1151
FAX: +64 9 306 8203
NZ Customer Care 0800 002 999

Australia Contact

Brand Developers Aust Pty Ltd
461 Plummer Street,
PORT MELBOURNE, VIC 3207
FAX: +61 3 9681 7825
AUST Customer Care: 1800 890 840

Distributed by:

Brand Developers Aust Pty Ltd

461 Plummer Street
PORT MELBOURNE, VIC 3207
FAX: +61 3 9681 7825
AUST Customer Care: 1800 890 840



Brand Developers Ltd

Unit H, 686 Rosebank Road,
Avondale, 1026 Auckland,
NEW ZEALAND
FAX: +64 9 306 8203
NZ Customer Care: 0800 002 999



Copyright © Euro-Pro Operating LLC 2014

Printed in China

Illustrations may differ from actual product.

Euro-Pro, Nutri Ninja, AUTO-iQ, Sip & Seal, Pro Extractor
Blades and Ninja are trademarks of Euro-Pro Operating LLC.

BL480NZ_70_IB_E_140821_1



TUV017304EA