

Luvele

Luv life. Luv health.

Luvele Deluxe PRO Vacuum Sealer



Safety

Please be sure to read all instructions before using the Luvele Deluxe PRO Vacuum Sealer. Keep these instructions for future reference.

- Remove all packaging material before using your Vacuum Sealer for the first time.
- Do not place your Vacuum Sealer near the edge of a bench or table during operation. Ensure the surface is level, free of liquids or other substances.
- Do not place your Vacuum Sealer on or near a hot stove or oven.
- Do not touch the hot sealing element located on the edge of the bottom of the Vacuum Sealer, as it may be very hot.
- Use only recommended bags and or attachments with your Luvele Vacuum Sealer, and do not use this appliance for any other purpose except for its intended use.
- Do not place any parts of the Vacuum Sealer in a dishwasher or microwave oven.
- Do not immerse the Vacuum Sealer in water or other liquids.
- Never operate damaged appliance (incl. Mains cable).
- Operate appliance only through a professionally installed socket supplying the correct voltage and do not use extension cables.
- Never remove main cable with wet hands, or lay cable on hot surface, or let cable come into contact with oil.
- Unplug the appliance after each use, when the appliance is not in use and before changing accessories or cleaning appliance.
- Do not try and perform any maintenance, other than cleaning. For any maintenance issues please contact Luvele Australia at support@luvele.com.au
- Do not operate outdoors.
- This appliance is not intended for use by young children or infirm persons without supervision.
- Use a fire blanket only to extinguish fires on appliance.
- The appliance is not designed for commercial or industrial use, it is for household use only.



Congratulations

on the purchase of your new Luvele Deluxe PRO Vacuum Sealer

Safety

This appliance is intended to be used in household and similar applications such as:

- Staff kitchen areas in shops, offices and other working environments;
- Farm houses;
- By clients in hotels, motels and other residential type environments;
- Bed and breakfast type environments

This appliance is not intended for use by persons (including children) with reduced physical, sensory or mental capabilities, or lack of experience and knowledge, unless they have been given supervision or instruction concerning use of the appliance by a person responsible for their safety.

Children 8 years and above can use this appliance, however, they should be supervised to ensure that they do not play with the appliance. Children should now play with the appliance.

Cleaning and user maintenance shall not be made by children unless they are older than 8 years old and supervised.

Keep the appliance and its cord out of reach of children less than 8 years.

Check the power supply cord for damage from time to time. If the power supply cord is damaged, it must be replaced by the manufacturer or its service agent or a similarly qualified person in order to avoid a hazard.

Use only designated accessories enclosed. This appliance is not intended to be operated by means of external timer or separated remote-control system.

Features

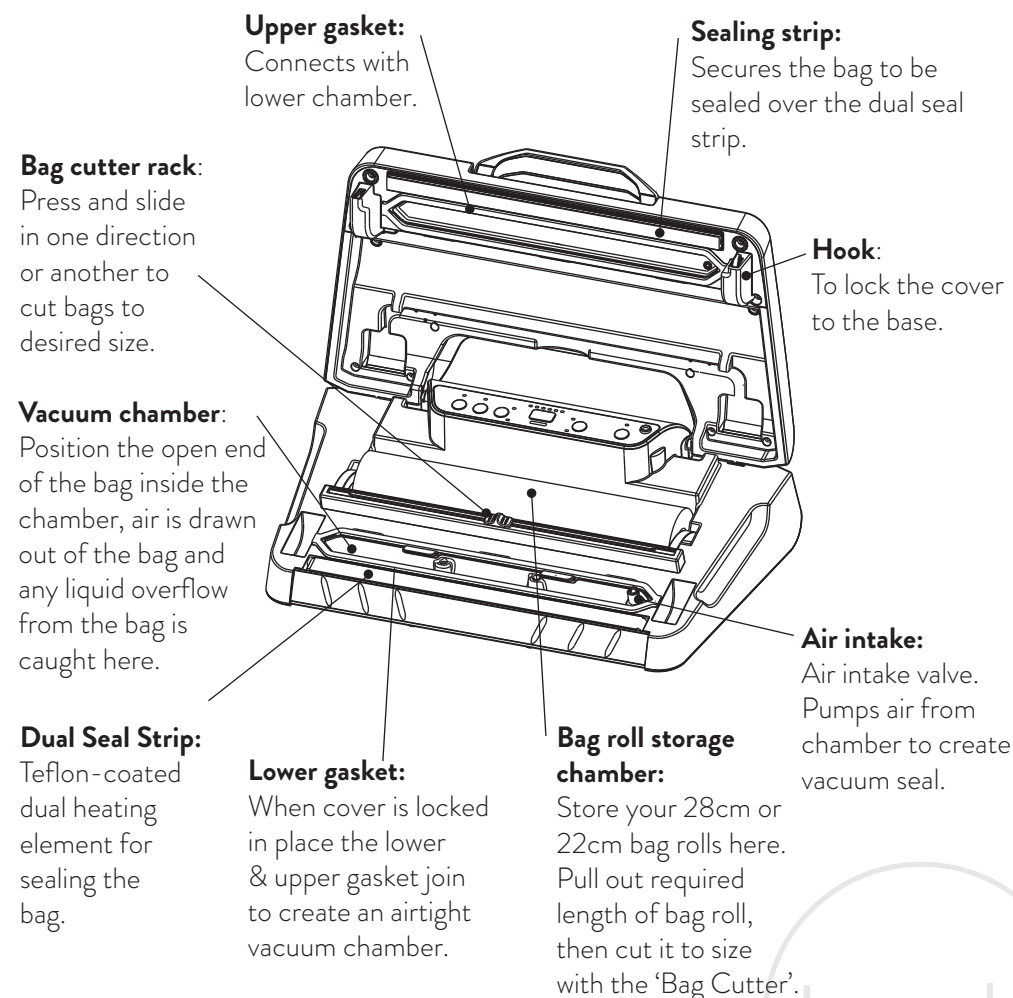

Features

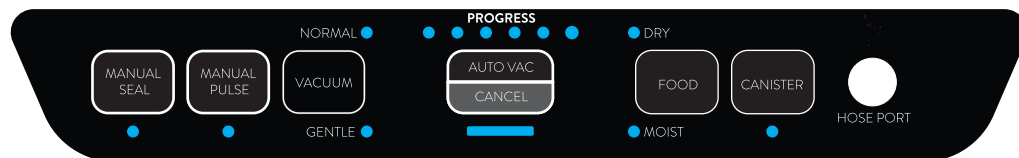

Manual Seal:

To manually seal the open end of a bag without vacuuming, used to make a bag from a bag roll.

Manual Pulse

The PULSE button is used when full control of the vacuuming process is required. For example, when vacuum sealing delicate, moist & liquid items, less vacuum pressure may be required before the bag is sealed.

Alternatively, a longer vacuuming time may be required when vacuum sealing firm & hard items. The PULSE button gives full control over how long you vacuum an item before pressing the MANUAL SEAL button.

Press and hold the PULSE button and the vacuum pump turns on, release the button and it shuts off. When the desired pressure is reached, press the MANUAL SEAL button to seal the bag.

Vacuum:

This button offers the choice of two different vacuum pressures:

NORMAL Setting: for regular items.

GENTLE Setting: for soft & crushable items where less vacuum pressure is required.

Default setting is normal vacuum pressure.

Food:

This button is used for choosing the best bag seal time:

DRY setting: This is used for dry food & will shorten the time the dual seal strip is on.

MOIST setting: Used for wet bags or foods with moisture, & will increase the time the dual seal strip is on.

Default setting is for dry bags and normal sealing time.

Auto Vac / Cancel:

This button has two functions depending on the machine's status:

AUTO VAC: When pressed in the standby mode it starts the vacuum sealer and commences automatic operation of vacuuming the bag and then automatically seals the bag when vacuum is complete.

CANCEL: If pressed when vacuum sealer is in operation, it will stop the machine.

Canister: To start vacuuming for canisters through a hose accessory. Canisters are available at luvele.com.au

Features

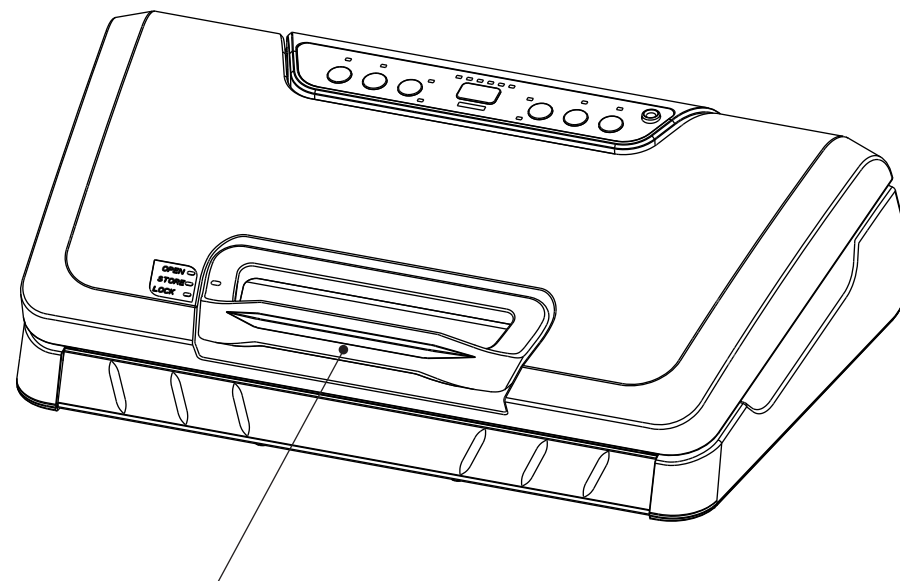

Easy Lock handle:

The 'Easy Lock Handle' has been designed so no pressure is required to close the lid and lock a bag into position ready for vacuum sealing. With a gentle push the easy lock handle clips the lid closed and vacuuming can begin. The easy lock handle also has a 'store' position, which it is used to store the vacuum sealer and prevent the foam gaskets from becoming damaged or compressed.

Open - In the open position the lid can be opened, ready for use.

Store - When storing the vacuum sealer, place the handle in the 'Store' position to prevent the foam gaskets from becoming damaged or compressed.

Lock - Place the handle in the 'Lock' position once a vacuum bag is in position, to begin vacuum sealing.

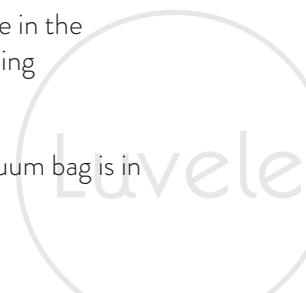

Operation

Making a bag with a bag roll

1. Plug the unit into a power source and then open the top cover.
2. Place a bag roll in to the bag roll storage chamber.
3. Lift up the bag cutter rack.
3. Pull the required length of the bag roll out and place it under the bag cutter rack.
4. Place the bag cutter rack down, making sure the bag cutter knob is fully to the left or to the right. Then slide the cutter knob from one end to the other end to cut the bag.
3. Put one end of the bag on top of the dual seal strip, but make sure the end does not enter the vacuum chamber.
4. Close the lid and place the 'Easy Lock Handle' in the 'Lock' position.
5. Press the 'Manual Seal' button to seal one end of the bag.
6. Lift the 'Easy Lock Handle' to the 'Open' position to open the cover and take the bag out of the machine. The bag is now ready for vacuum sealing.



Operation

Smart Seal Technology

Luvele's 'Smart Seal Technology' allows for up to 100 bag seals in a row without overheating the dual seal strip.

Other home style vacuum sealers generally require a 40 second break between bag seals, to allow the seal strip to cool.

The Luvele smart seal system manages the heat distribution of the dual seal strip to maintain an even and constant temperature throughout use.

PLEASE NOTE

The smart seal feature will take approximately 3-4 bag seals to warm-up. The first few bag seals may be a little slower, while the dual seal strip warms up. Please keep this in-mind when using the Luvele Deluxe PRO vacuum sealer.

Operation

Vacuum packaging with a bag

1. Put the items you wish to vacuum seal inside the bag. Use only the specially designed vacuum bags/rolls supplied.
2. Straighten the open end of the bag and make sure there is no dust or folds in the bag.
3. Place the open end of the bag within the vacuum chamber area. Make sure the air intake is not covered by the bag. Also, make sure the bag on the seal line is completely flat and that there is approximately 5cm of bag roll between the top of the item being sealed in the bag and the dual seal line.
4. Close the lid and place the 'Easy Lock Handle' in the 'Lock' position.
5. Check the LED status of the VACUUM button and the FOOD button.

If the item you are sealing is dry then select DRY on the FOOD button. If the item is moist then select MOIST on the FOOD button.

Then select the desired vacuum pressure with the VACUUM button. Select NORMAL for general items. If you need to seal delicate items then select the GENTLE button.

When you have set the FOOD button and VACUUM button to desired settings, then press the AUTO VAC button. The unit will then vacuum the bag and when complete will automatically seal the bag.

6. The vacuum packaging is now done. Lift the 'Easy Lock Handle' to the open position and take out the vacuum packed bag.

NOTE: Wipe out any excess liquid or food residue in the vacuum chamber after each vacuum seal. After 100 vacuum seals in a row, allow the vacuum sealer to cool down for 20 minutes.

The Luvele Deluxe PRO should only be used with specifically design vacuum sealer bags provided by Luvele.

Do not attempt to use other bags not intended for vacuum packaging. Cut the bags straight across with scissors to open a sealed bag.

Storage

Storage time will vary depending on the freshness of foods that are being vacuumed packaged. The fresher the foods the longer the storage time will be.

The main element that causes food to lose its nutritional value, texture, flavor, and overall quality is oxygen. Vacuum packaging helps to extend the life of foods by removing most of the oxygen in a sealed bag or container. Removing oxygen from stored foods helps to inhibit the growth of micro-organisms. There are three main types of micro-organisms that effect stored foods. They are mould, yeast and bacteria.

- Mould: Easy to identify due to its characteristics fuzz. Moulds cannot grow in vacuum packaging because of the low oxygen environment. Therefore, vacuum packaging eliminates mould.
- Yeast: Yeast is the fermentation of foods. It can be identified by smell or taste. Yeast requires sugar and a moderate temperature to grow and it can grow with or without air. Refrigeration will slow the growth of yeast and freezing stops it completely.
- Bacteria: Bacteria can grow with or without air. Bacteria results in discoloration, soft or slimy texture and an unpleasant smell. The best way to combat bacteria is to both vacuum pack and freeze foods.

Storing foods at low temperatures is critical for preserving foods safely. Growth of micro-organisms is reduced at temperatures below 4° C. Storing foods at -17°C will not kill micro-organisms but it will stop them from growing. For the best results freeze perishable foods that have been vacuumed sealed.

Thawing and heating vacuumed packages foods

Always thaw frozen foods in the refrigerator or microwave. Do not leave foods to thaw at room temperature. When microwaving a vacuumed packaged food cut a corner of the bag and place on a microwave safe tray.

You can reheat foods in a vacuum sealed bag by placing in water at a low simmer

More storage information available on page 17 & 18

Tips

Vacuum Packaging Meat & Fish

For the best results when vacuum packaging meats and fish, pre-freeze for 1-2 hours before vacuum packaging in bag. This helps meats to retain their shape and prevents any liquids from overflowing into vacuum sealer.

Vacuum Packaging Cheese

To keep cheese fresh you can vacuum pack after each use. Make the bag extra long when sealing for the first time. Cut sealed edge when you're ready to use cheese. To re-package simply place the cheese back in to the bag and re vacuum seal.

Vacuum Packaging Vegetables

Vegetables need to be blanched before vacuum packaging. This stops enzymes from effecting the flavor, colour and texture of the vegetable. To blanch vegetables, place in boiling water for approximately 1 minute. After blanching place the vegetable in to iced cold water to stop the cooking process. Then dry vegetables on paper towel before vacuum packaging.

Note: Cruciferous vegetables such as broccoli, Brussels sprouts, cabbage and cauliflowers naturally emit gases during storage. Therefore, after blanching and vacuum packaging they must be stored in freezer only. Mushrooms and garlic should not be vacuumed packed.

Vacuum Packaging Fruits

Fruits can be vacuumed sealed whole or sliced. For longer lasting storage place fruits in freezer.

Vacuum Packaging Coffee or Powdery Foods

To prevent food particles from being drawn into vacuum pump place a coffee filter or piece of paper towel at the top of bag before vacuum packaging. You can also place the food in its original bag inside a vacuum sealer bag.

Vacuum Packaging Liquids

Before vacuum packaging liquids such as stock, pre-freeze in a ice cube tray until frozen. Place frozen cubes into vacuum sealer bag. When ready to use place frozen cube straight in to dish being prepared

Tips

Vacuum Packaging for Marinating

Vacuum sealing opens the pores in foods such as meats, poultry and seafood absorbing marinades much faster than traditional methods. When vacuum sealing marinades do not overfill bag. This will ensure that liquid does not enter the vacuum chamber.

Re-sealing Chip Packets

You can utilise the seal strip to re-seal packaging that has already undergone a commercial quality seal. This allows half consumed packets of chips, crackers and cereals to be resealed by placing on sealing strip. When resealing, ensure that the bag does not reach into the vacuum chamber, as it will crush delicate items. Use this method to reseal suitable packets only.

Tips for Vacuum Packaging Non-Food Items

The Luvele Deluxe PRO Vacuum Sealer can also be used to protect non-food items from corrosion, oxidation and moisture. The same process can be used to vacuum seal non-food items as food items.

Vacuum Packaging Silverware & Cutlery

When vacuum packaging silverware and cutlery make sure all sharp edges are covered with a cushioning material such as paper towel to avoid puncturing bag.

Vacuum Packaging First Aid Kits

Vacuum packaging first aid kits to store in your home, boat or car is a great way to keep items dry and free from dirt and mould. Also consider vacuum sealing flares, batteries, flashlight, candles and matches.

Vacuum Packaging for Outdoor Activities

When camping vacuum packing your clothes can save space in your bag and keep dry at the same time. Also, vacuum seal your maps, matches and snacks.

Vacuum Packaging paint brushes

When painting around the home you can vacuum package your wet paint brushes between coats rather than washing. This is particularly useful for oil based paints that require mineral turpentine to clean.

Vacuum Packaging Ice

You can vacuum package ice to use as an icepack for picnics and other outdoor activities. When the ice melts you then have fresh drinking water or refreeze to use again as an icepack

Trouble shoot**Nothing happens when I try to vacuum seal a bag**

- Check power cord to see if it is firmly plugged into electrical outlet.
- Examine power cord for any damage.
- See if electrical outlet is functioning by plugging in another appliance.
- Make sure the bag is placed correctly inside vacuum chamber and beneath the air intake.
- Make sure there is 5cm of flat bag between the top of the item in the vacuum bag and the dual seal line. The bag needs to be completely flat on the dual seal line.

Air is not removed from the bag completely

- To seal correctly, the open end of the bag should be resting entirely inside the vacuum chamber area.
- Check dual seal strip and the foam gaskets for debris and position. Make sure there is no breaking or distortion of the foam gaskets on both the cover and on the base of the vacuum chamber. Wipe clean and smooth them back into place if needed.
- Vacuum bag may have a leak. To test, seal the bag with some air in it, submerge in water, and apply pressure. Bubbles indicate a leak. Reseal or use another bag.
- Use only the specified vacuum bag with vacuum channels provided by Luvele.
- Leaks along the seal can be caused by wrinkles, debris crumbs, grease or liquids. Reopen bag, wipe the top inside of the bag and smooth it out along the sealing strip before resealing.
- There is a vacuum pressure sensor built in this machine. The machine will not turn to seal automatically if the vacuum pressure inside the bag is not able to reach the predetermined vacuum pressure. Check sealing strip and the foam gasket beneath the lid for debris and correct position. Wipe clean and smooth them back into place, and try again.

The bag melts

- Should the dual seal strip overheat and melt the bag, it may be necessary to lift the lid and allow seal strip to cool for a few minutes.

Trouble shoot**Air has re-entered into the bag after being sealed**

- Leaks along the seal can be caused by wrinkles, debris crumbs, grease or liquids. Reopen bag, wipe the top inside of the bag and smooth it out along the sealing strip before resealing.
- The release of natural gases or fermentation from foods such as fresh fruits and vegetables may occur. Most vegetables require blanching prior to vacuum packaging.
- Open bag if you think food has begun to spoil, and discard food. Lack of refrigerator or fluctuating temperatures in the refrigerator can cause food to spoil. If food is not spoiled then consume food immediately.
- Check the bag for a puncture or hole which may have released the vacuum. Do not vacuum package hard items with sharp points like bones or shell. Cushion sharp edges in the contents of the bag with paper towels.

Vacuum Sealing moist or liquid items

Many troubles faced when vacuum sealing are from trying to seal moist or liquid items. Moist items are more difficult to vacuum seal because the moisture in the bag naturally wants to get sucked towards the seal area where the vacuuming is taking place. If the moisture reaches the seal line the vacuum sealer will automatically start to seal the item. This can happen while there is still air in the bag and can give the appearance that the vacuum sealer is not working correctly.

Following are some tips to overcome this:

- If attempting to seal moist meats like fish and chicken, it is recommended that you cut your vacuum bag with extra length, so there is room for the moisture to move during the vacuuming process and so the moisture does not reach the seal line. 15cm should be enough length from the end of the meat item to the seal area.
- Another solution to sealing high moisture items is to wrap them in plastic wrap then place them in the vacuum bag to be vacuum sealed. This should prevent most of the liquid being sucked towards the seal area.
- If placing large moist items in a bag like a whole fish, it is very important you do not leave any moisture near the seal area. Once you have placed this type of item in the bag use some dry paper towel to wipe down the seal area for a successful outcome.
- Liquid items like soups, stocks, gravy etc should all be frozen before attempting to seal.

Safety

Cleaning your Vacuum Sealer

1. Always unplug the unit before cleaning.
2. Do not immerse in water or any other liquid.
3. Avoid using abrasive products or material to clean the unit, for they will scratch the surface.
4. Use a mild dishwashing soap and a warm, damp cloth to wipe away food residue or around components.
5. Dry thoroughly before using again.

Note: The foam gaskets around the vacuum chamber should be dried thoroughly before storing. If removal and re-assembling of foam gaskets is required, then be careful to position them correctly to ensure no vacuum leakage.

Cleaning vacuum bags

1. Wash bags in warm water with a mild dishwashing soap
2. When washing bags in dishwasher, turn bags inside out and spread them over top rack of dishwasher, so entire surface is exposed to the wash.
3. Dry thoroughly before reusing.

IMPORTANT: To avoid possible illness, do not reuse bags after storing raw meats, raw fish or greasy foods. Do not reuse bags that have been microwaved or boiled.

Storing Your Vacuum Sealer:

1. Keep the unit in a flat and safe place, out of the reach of children.
2. Remember to make sure the 'Easy Lock Handle' is in the 'Store' position when storing, to protect the foam gaskets.

Storage

Foods	Where to store	Storage life when vacuumed sealed	Normal storage life
Meat			
Beef, Pork, Lamb	Freezer	2-3 years	6 months
Ground Meat	Freezer	1 year	4 months
Poultry	Freezer	2-3 years	6 months
Fish	Freezer	2 years	6 months
Hard Cheeses			
Cheddar, Swiss	Refrigerator	4-8 months	1-2 weeks
Parmesan	Refrigerator	4-8 months	1-2 weeks
Vegetables (Most vegetables need to be blanched before vacuum sealing)			
Asparagus	Freezer	2-3 years	8 months
Broccoli, Cauliflower	Freezer	2-3 years	8 months
Cabbage, Brussels Sprouts	Freezer	2-3 years	8 months
Corn (cob or kernel)	Freezer	2-3 years	8 months
Green Beans	Freezer	2-3 years	8 months
Lettuce, Spinach	Refrigerator	2 weeks	3-6 days
Snow Peas, Snap Peas	Freezer	2-3 years	8 months
Fruits			
Apricots, Plums	Freezer	1-3 years	6-12 months
Peaches, Nectarines	Freezer	1-3 years	6-12 months
Softer Berries			
Raspberries, Blackberries	Refrigerator	1 week	1-3 days
Strawberries	Refrigerator	1 week	1-3 days
Harder Berries			
Blueberries	Refrigerator	2 weeks	3-6 days
Cranberries	Refrigerator	2 weeks	3-6 days

Storage

Foods	Where to store	Storage life when Vacuumed sealed	Normal storage life
Baked Goods			
Bagels, Bread, Pastries	Freezer	1-3 years	6-12 months
Nuts			
Almonds, Peanuts	Pantry	2 years	6 months
Sunflower Seeds	Pantry	2 years	6 months
Coffee			
Coffee Beans	Freezer	2-3 years	6 months
Coffee Beans	Pantry	1 year	3 months
Ground Coffee	Freezer	2 years	6 months
Ground Coffee	Pantry	5-6 months	
Prepared Liquids			
Sauces, Soups, Stews	Freezer	1-2 years	3-6 months
Dry Foods			
Beans, Grains	Pantry	1-2 years	6 months
Pasta, Rice	Pantry	1-2 years	6 months
Powdery Foods			
Dry Milk	Pantry	1-2 years	6 months
Dried Coconut	Pantry	1-2 years	6 months
Flour	Pantry	1-2 years	6 months
Sugar, Brown Sugar	Pantry	1-2 years	6 months
Snack Foods			
Chips	Pantry	3-6 weeks	1-2 weeks
Cookies, Crackers	Pantry	3-6 weeks	1-2 weeks

Warranty

The Luvele Deluxe PRO is backed by our 2 Year Total Cover Warranty. Our warranty will covers any manufacturing fault with the product and will also cover damage caused during transit.

Your warranty starts from the purchase date of your Luvele product. Please visit www.luvele.com.au to register your warranty. Further instructions can be found on your warranty card.

Warranty Process

We want to make any warranty claim as simple as possible for you. All you need to do is contact us at support@luvele.com.au and provide us information about the problem you are having with your item. Firstly, we will suggest some troubleshooting ideas to establish whether or not the issue can be fixed without a return. Photos of the fault may be requested if and where appropriate, and if it will ensure a faster resolution.

Generally, if you have an issue with your item within 30 days of receiving it, we will email you a prepaid return label that can be printed out and used to send the item back with. We will then generally send you a brand new item. The new item will be shipped within 48 hours of receiving the faulty item back. A confirmation email will be send when your faulty item is received back.

If you have an issue after the 30 day period we will consider repairing your item if suitable. If it cannot be repaired it will be replaced with a brand new item. Refunds will only be offered within the 30 day money back guarantee, if you choose this option over a new replacement. Outside of this 30 day period, your item will be repaired or replaced.

We are here to help, so please email us and the best solution to meet your needs will be offered. support@luvele.com.au | www.luvele.com.au