

Scan the QR
code to watch the
assembly video

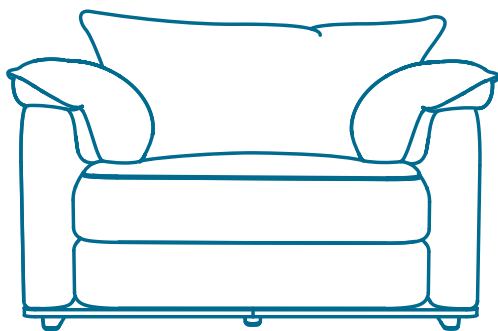

CUSHY
SOFA BED



1. open the seat cushion.
due to compression,
max comfort reached after 3-5 day.s

Scan the QR
code to watch the
assembly video

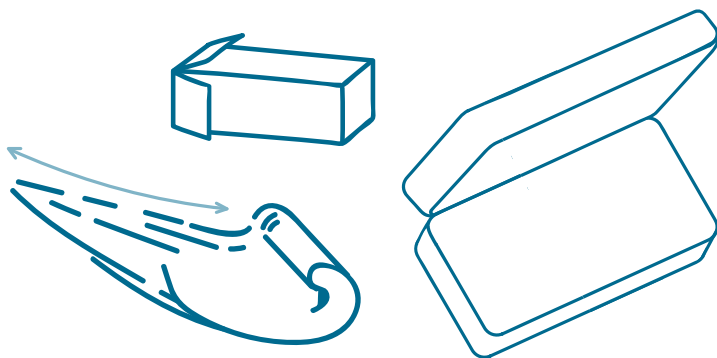

-
2. remove cushions from backrest

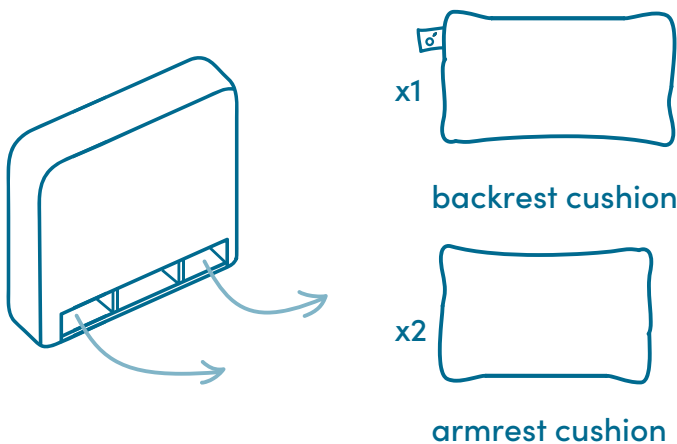

3. connect baseboards

Scan the QR
code to watch the
assembly video

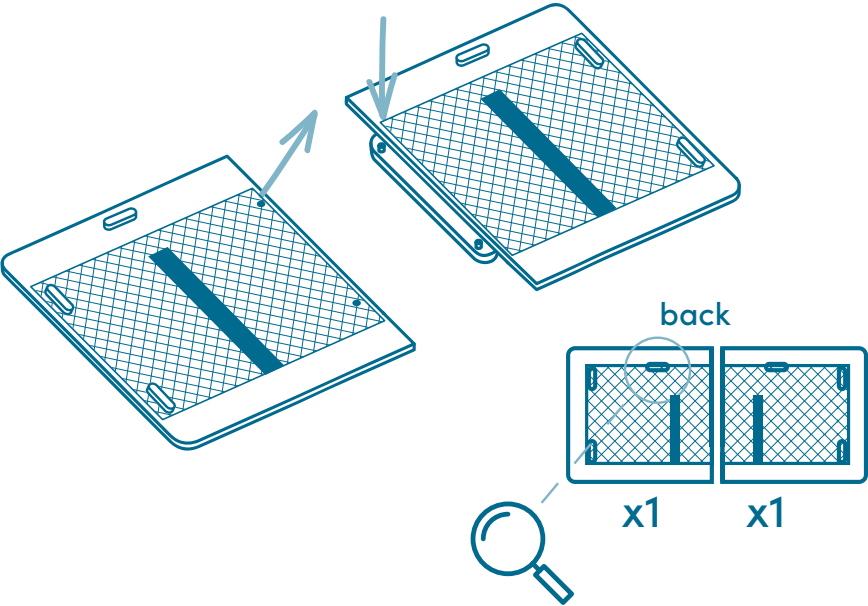

4. align and fit the backrest

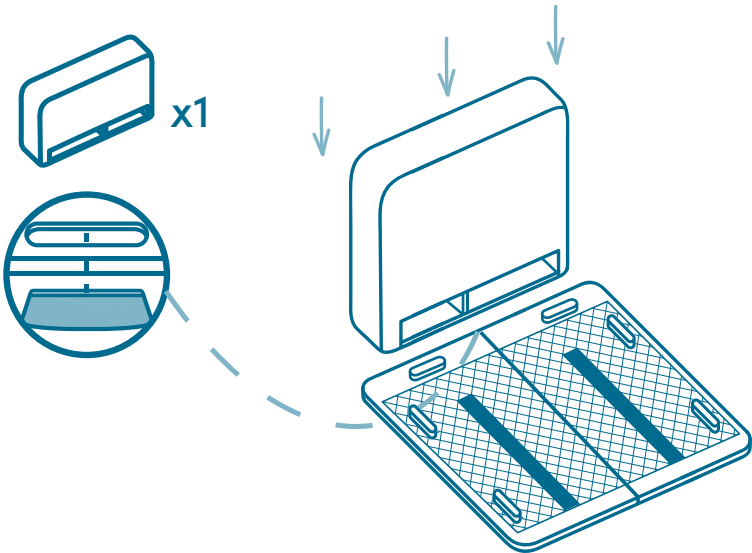

5. press down to ensure arm connector is fully locked into backrest connector

Scan the QR code to watch the assembly video

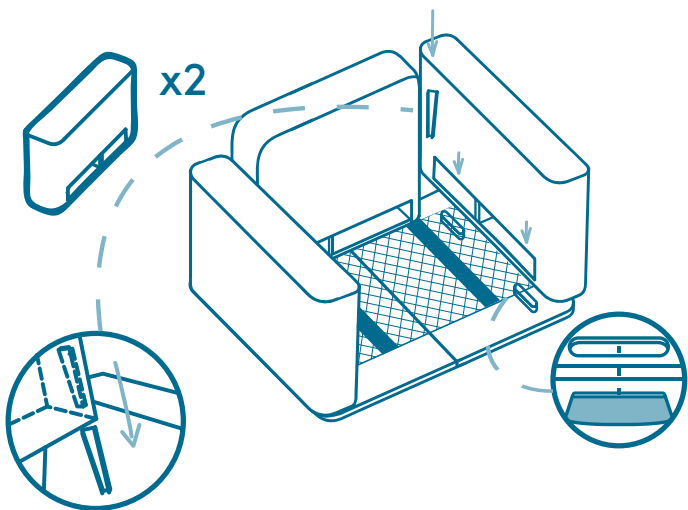

6. keep gumnuts loose

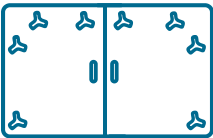
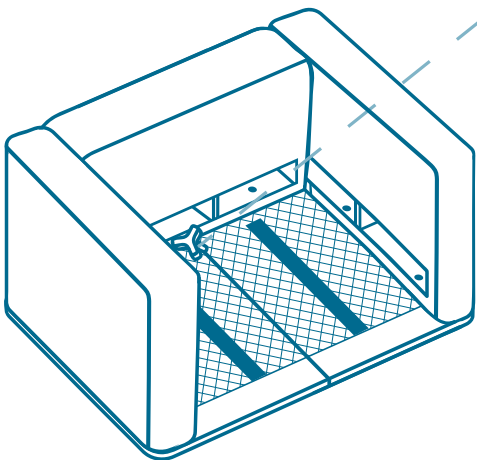

7. tighten all gumnuts, but there is
no need to overtighten

Scan the QR
code to watch the
assembly video

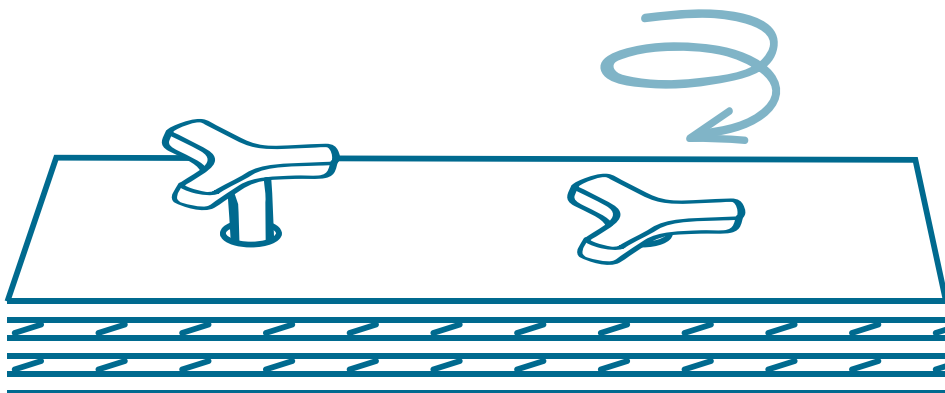

8.  x1 align cushion between arms

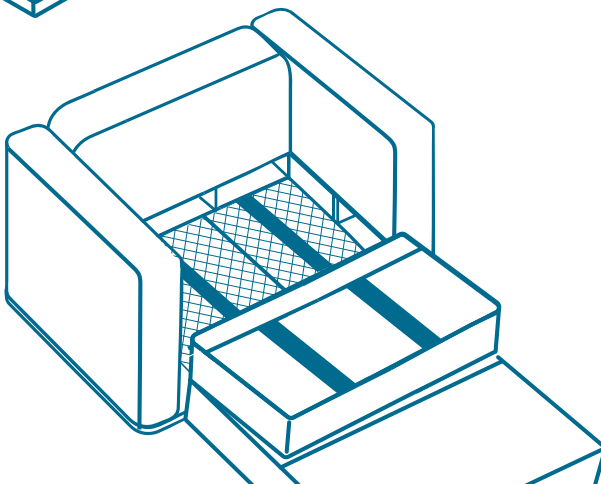

9. align the velcro and flip cushion

Scan the QR
code to watch the
assembly video

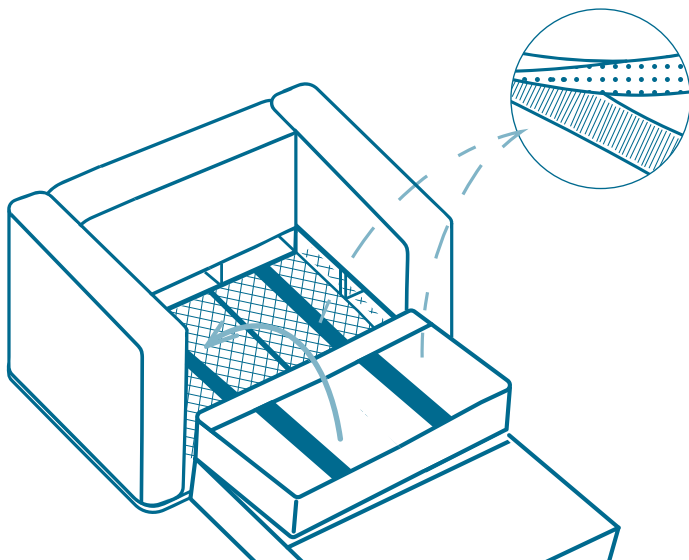

10.

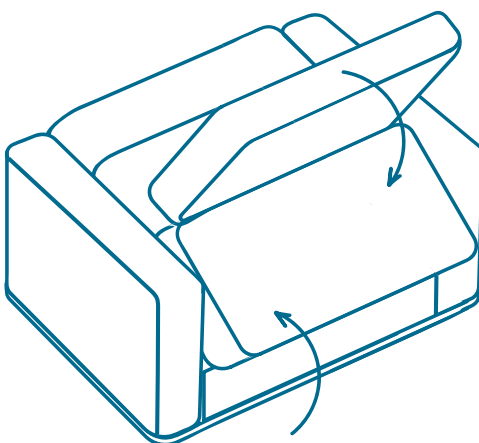

11. note backrest cushion tag

Scan the QR
code to watch the
assembly video

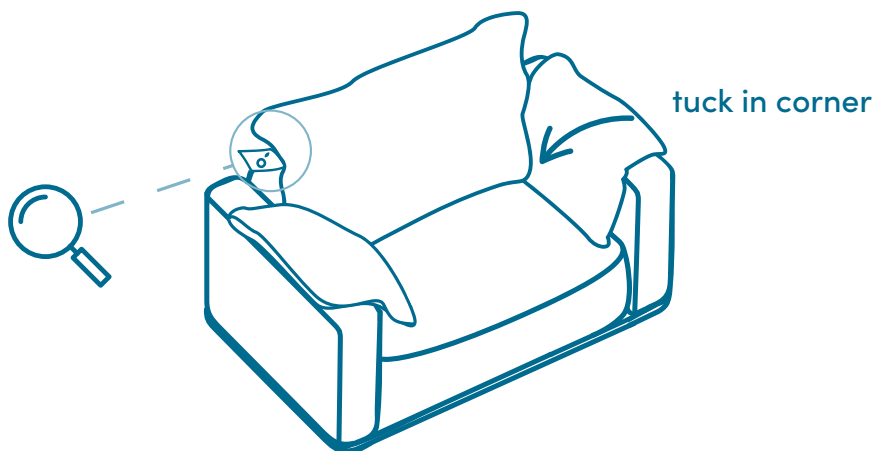

12. i bed you didn't see that coming.

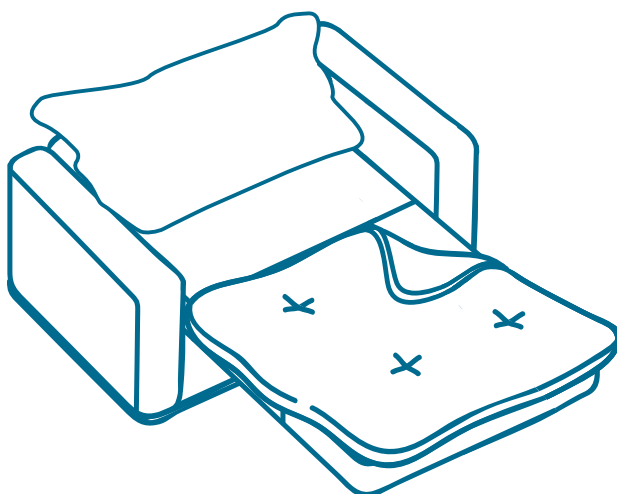

Scan the QR
code to watch the
assembly video

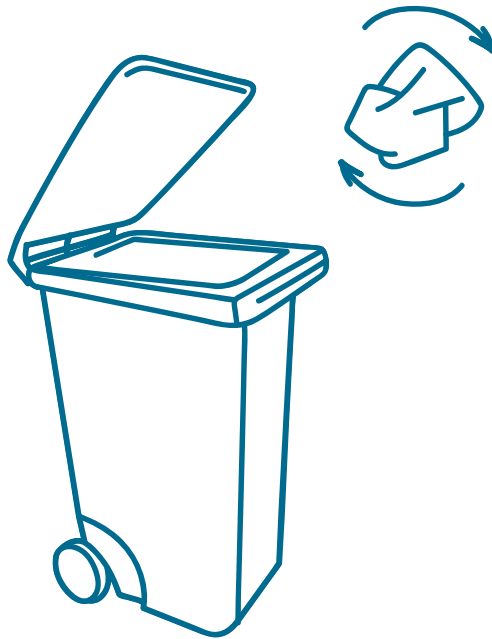

don't forget to recycle.

kóala