

ELECTRIC SINGLE 60cm OVENS

USER AND INSTALLATION INSTRUCTIONS

VENINI

Dear Customer,

Congratulations on purchasing your new product from Think Appliances.

To register your parts and labour warranty (some conditions apply please refer to your warranty card for more details) please contact our Customer Care team on:

1800 444 357

Our Customer Care centre is there to ensure you get the most out of your appliance. For example, should you want to learn more about recommended cooking temperatures, the various cooking functions available, how to set and program your LED clock, and importantly taking care of your appliance when cleaning, please call us because we are here to help you.

It is important that you read through the following use and care manual thoroughly to familiarize yourself with the installation and operation requirements of your appliance to ensure optimum performance.

We also carry a complete range of spare parts for all Think products. For all your spare parts enquiries please contact our team at Pronto Parts on:

1300 306 973

Again, thank you for choosing an appliance brought to you by Think Appliances and we look forward to being of service to you.

Kind regards

Management

Think Appliances

For future reference please record the following information which be found on the Rating Plate and the date of purchase which can be found in the invoice:

Model Number

Serial Number

Date of Purchase

CONTENTS

General Information	page 3-4
Warning and Safety Instructions	page 5-6
Instructions for Use	pages 7-11
Instructions for Installation	pages 12-18
Technical Data	page 19

GENERAL INFORMATION

Please read this booklet thoroughly before you use this appliance. It is important that you understand all the control functions before commencing to cook with your Sorrento appliance.

Please remember the advice and warnings shown on page 5 which is headed 'IMPORTANT – Warning and Safety Instructions'.

This appliance is designed for domestic household use and can be built into a standard kitchen cabinet or housing unit.

NOTE: The adjacent furniture or the housing and all materials used in the installation must be able to withstand a minimum temperature rise of 85°C above ambient during periods of use.

Certain types of vinyl or laminate kitchen furniture are particularly prone to heat damage or discolouration at temperatures below the above guidelines.

Installing the appliance in contravention of this temperature limit or the placing of adjacent cabinet materials closer than 4mm to the appliance, will be at the liability of the owner.

The use for any other purpose or in any other environment without the express agreement of Sorrento Appliances, would invalidate any warranty or liability claim

Your new appliance is guaranteed against electrical or mechanical defects subject to certain exclusions noted in Sorrento Conditions of Guarantee.

The foregoing does not affect your statutory rights.

For Warranty conditions in Australia please consult the enclosed Cucina Australia Warranty card, or call Cucina National Service on 1800 444 357.

Before using this appliance ensure that any protective packaging or coatings have been removed. To aid the protection of the environment, please sort the packing materials into different types and dispose of them in accordance with the local waste disposal laws.

Any further information on waste disposal can be obtained from your local Environmental Agency office.

When first used, an odour may be emitted by any residual protective finish or moisture, which will cease after a short period of time.

This Appliance has been Constructed and Distributed in compliance with the essential requirements of the following EEC DIRECTIVES and EUROPEAN NORMS:-

**CE Marking – 93/68 Low Voltage – 73/23 EMC – 89/336
Safety Standards – EN 60 335-1, EN 60 335 – 2 – 6, AS/NZS 3350 - 1 , AS/NZS 3350 – 2 – 6.**

As Sorrento have a policy of continued product improvement, the right is reserved to adjust and make any modifications deemed necessary without notification.

IMPORTANT NOTE – WARNING AND SAFETY INSTRUCTIONS

This appliance complies with all current European safety legislation, however Sorrento do wish to emphasise that compliance does not remove the fact that the appliance surfaces will become hot during use and retain heat after operation.

Sorrento therefore strongly advise that the appliance is not intended for use by young children or infirm persons without supervision. Young children should be supervised to ensure they do not play with the appliance. If it is necessary for younger family members to be in the kitchen, please ensure that they are kept under close supervision at all times.

We also advise that great care is taken during use and cleaning operations.

Do not place heavy objects on or lean on the oven door when open as this can cause damage to the hinging.

Do not leave heated oil or fat unattended as there is a risk of fire.

Do not place pans or baking trays on the bottom of oven cavities or line with Aluminium Foil.

Do not allow electrical fittings or cables to be in contact with hot areas of the appliance.

Do not use the appliance for space heating or to dry clothes.

Do not install the appliance next to curtains or soft furnishings.

Do not attempt to lift or move cooking appliances by pulling on any door or handle as this can cause damage.

NOTE: This appliance must be correctly installed by a suitably qualified person, strictly in accordance with the manufacturer's instructions.

For electrical installations, NICEIC registration is recommended.

Sorrento declines any responsibility for injury or damage to persons or property as a result of improper use or installation of this appliance.

Heat, steam and moisture will be created during use, take care to avoid injury and ensure that the room is adequately ventilated. If prolonged use occurs, additional ventilation may be required – please consult your Qualified Installer if you are in any doubt about the amount required.

INSTRUCTIONS FOR USE

These User Instructions should be retained for future reference and for use by a person who is perhaps unfamiliar with the appliance.

The following model is covered by these instructions:

SFF06 - VEO6001 - VFFO6SS - VFFO6W - VO6SFS

USING THE OVEN

Before your ovens first use it is suggested to do a “burn in”. This involves turning the oven onto the fan oven setting at 200°C for 15 minutes, then select the conventional mode for a further 15 minutes. You will notice an amount of smoke come from the oven. This is the protective oil coating burning off the elements. This is quite normal. You are now ready to start cooking.

The oven is controlled thermostatically between 50°C and or 250°C depending on the temperature required. The thermostat pilot light switches ON and OFF to indicate temperature control during periods of operation.

The mode of cooking desired is selected by using the multifunction control knob. The functions (dependent on model) that can be selected are as follows:



OVEN LIGHT Automatic when cooking mode is selected. The oven light remains on whilst the oven is in use.



DEFROST MODE (all models).
The fan runs without heat to reduce the defrost time for frozen food.



FAN OVEN MODE

This provides even heating with the fan and allows different dishes to be cooked on different levels at the same time.



GRILL MODE

Select the required temperature by turning the thermostat regulator clockwise.



GRILL AND FAN

The top centre heating element is turned on and its heat is distributed by the fan resulting in perfectly grilled meat without the need to turn. It is ideal for small cuts such as chicken pieces and racks of lamb.

WARNING

- Keep the oven door CLOSED when using the GRILL.
- The top shelf position is to be used for GRILLING ONLY.
- Do not use aluminium foil to cover the grill pan or heat items wrapped in aluminium foil under the grill – the high reflectivity of the foil can damage the grill element.
- Do not place Aluminium foil or metal trays directly on the base of the oven as this will cause damage to the enamel surface and is not covered by the Warranty.

HELPFUL HINTS

- Before cooking, check that any unused accessories are removed from the oven.
- Preheat the oven at cooking temperature before use.
- Place cooking trays in the centre of the oven and allow gaps when using more than one tray for air to circulate.
- Try to open the door as little as possible to view food (the oven light remains on during cooking).
- Be careful when opening the door to avoid contact with hot parts and steam.

COOKING GUIDELINES

Please refer to the information on food packaging for guidance on cooking temperatures and times. Once familiar with the performance of your appliance, the temperatures and times can be varied to suit personal preferences.

Make sure that frozen foods are thoroughly thawed before cooking, unless instructed otherwise.

Removing the shelf supports (Only applicable for models with wire shelf supports)

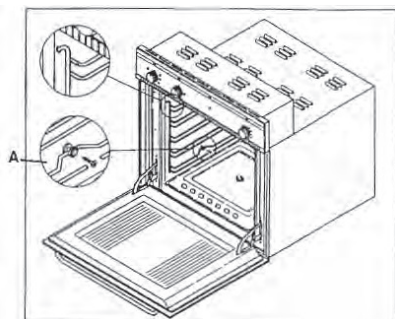

The shelf supports can be removed from the oven for cleaning by hand or in a dishwasher.

Grasp the shelf support and press downwards to release from the clip device on the lowest runner.

The shelf support can then be hinged upwards and lifted from the mounting holes in the upper corners of the oven prior to removal.

To re-fit the shelf supports, reverse the procedure, ensuring that the clip device engages firmly on the lowest runner.

120 MINUTES CUT-OFF TIMER

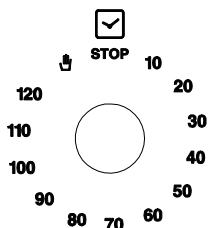

The function of the programming timer is to turn on the oven for a pre-determined amount of time.

Operating:

After having set the oven, switch knob at the desired temperature, turn the timer knob in a clockwise direction to the desired cooking time (max. 120 minutes). When the timer will return to position "0", a minute counter ringing will advise that the oven will automatically turn off.

Manual position:

If the cooking time is longer than the 2 hours programme, or if you wish to use the oven manually, to turn it off when you desire, turn the knob to manual position.

USING THE 60 MINUTES TIMER

This run-back timer can be used independently of an oven cooking cycle for up to 60 minutes of timing.

- 1) To set the timer, turn the knob fully clockwise until it stops and then back to the required time.
- 2) After expiry of the set time, the timer will have returned to position '0' and an acoustic signal will be briefly emitted.

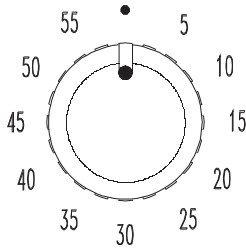

CLEANING THE APPLIANCE

Always allow the appliance to cool down before cleaning to avoid a burn injury.

Do not use caustic or abrasive agents, coarse wire wool or hard tools as these can damage the surface finishes.

Normally, wiping with a soft cloth dampened with hot detergent is sufficient, but for stubborn marks the following is recommended:

VITREOUS ENAMEL PARTS

Use only a non caustic cleaner that is recommended for this type of material – avoid chloride-based products such as bleach.

DOOR GLASS

Do not use any abrasive medium that could cause damage. Remember that if the surface of the glass panel becomes scratched, this could lead to a dangerous failure.

To facilitate cleaning, the door glass can be lifted out after removing the fixing screws.

When refitting, make sure that the glass is correctly seated in the door recess and the correct way round.

REMOVING THE OVEN DOOR

To facilitate cleaning inside the oven, the door can be removed as follows:

- 1) Ovens mounting hinges with movable bolts: The hinges are provided with two movable bolts (B). When the bolt is raised, the hinge (A) can be released from its housing.
- 2) Hold the door on each side, then lift to unhook the hinge mechanism and pull outwards to release from the oven. Grip the sides of the door near the hinges when performing these operations.
- 3) To refit, hold the door in the fully open position and slide the hinge arms (A) into the oven recesses until the arms lock in position. On models with hinge mechanisms, rotate the two movable bolts (B) and close the door fully to complete the refitting.

WARNING

- **Take care not to dislodge the hinge lock system when removing the door as the hinge mechanism has a strong spring system!**
- **Do not immerse the door in water at any time.**

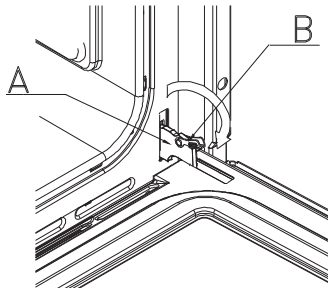

REMOVING AND REFITTING THE OVEN DOOR (1-6) - VO6SFS

The door can be hooked on both sides.

Warning: once completed the operation, check the door is correctly hooked.

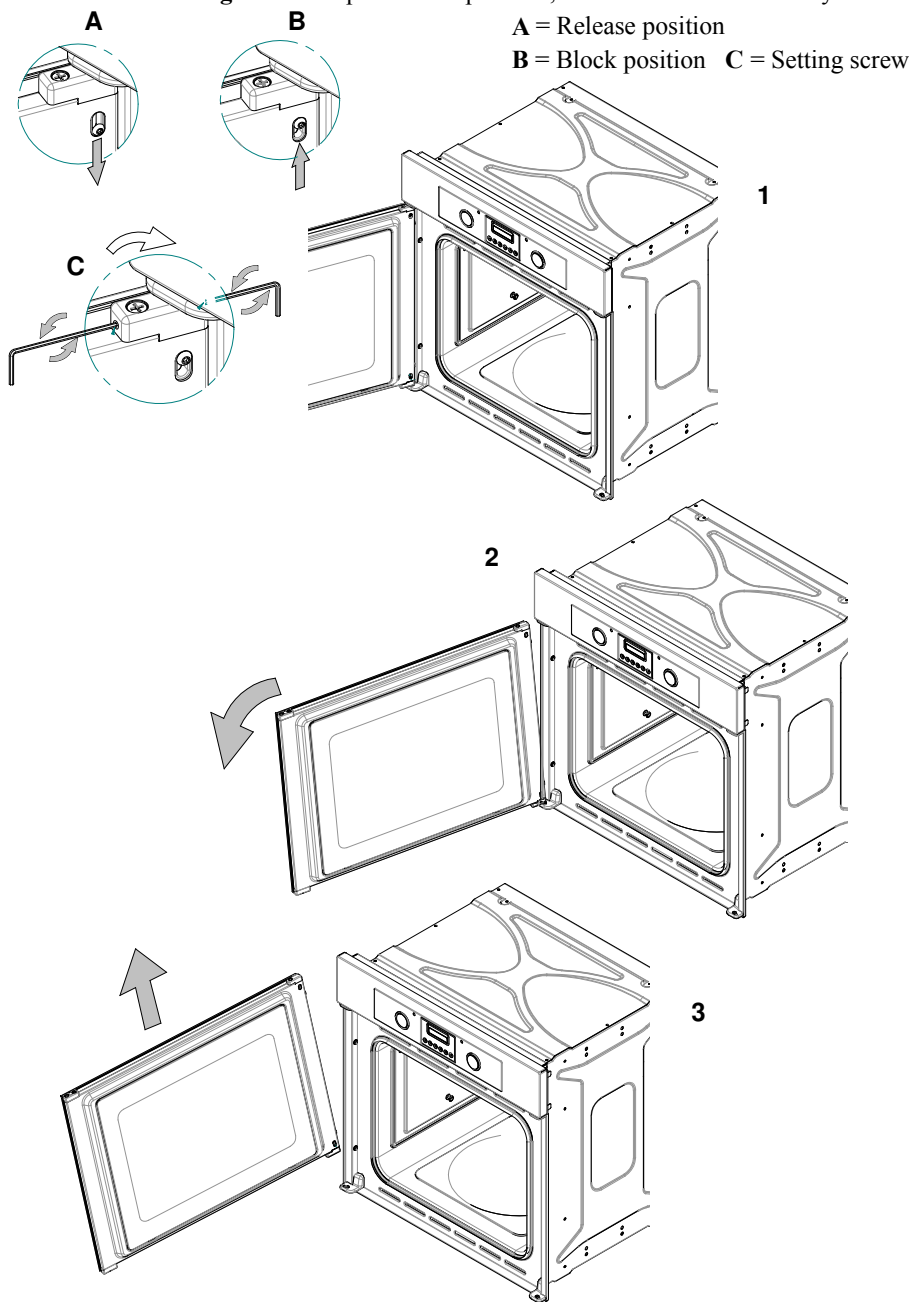

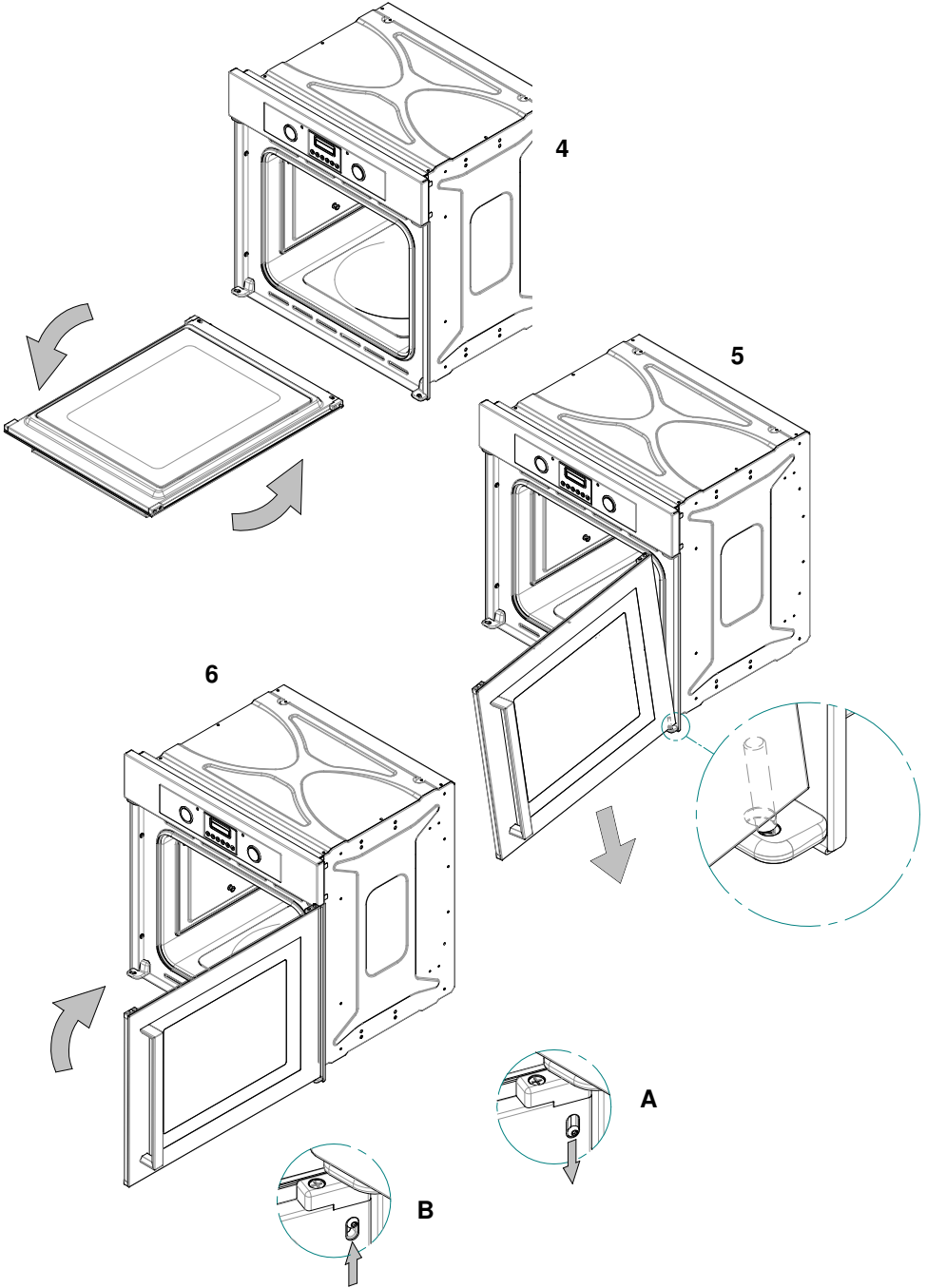

REMOVING THE OVEN DOOR INNER GLASS PANEL - VO6SFS

Do not use any abrasive medium that could cause damage.

Remember that if the surface of the glass panel becomes scratched, this could lead to a dangerous failure.

Never clean the appliance with high pressure water or steam cleaning equipment.

To remove the oven door inner glass panel, use a coin to perform a levering action in the two grooves (A) until the two pins (B) are released from their housing (pic. 1).

Then raise the glass as shown in pic. 2 and take it out from the top.

To refit the door, repeat the two previous operations in reverse.

Reinsert the glass by resting it on the inner door and pushing it in.

Press on the glass until the pins slot back into their initial position (pic. 2).

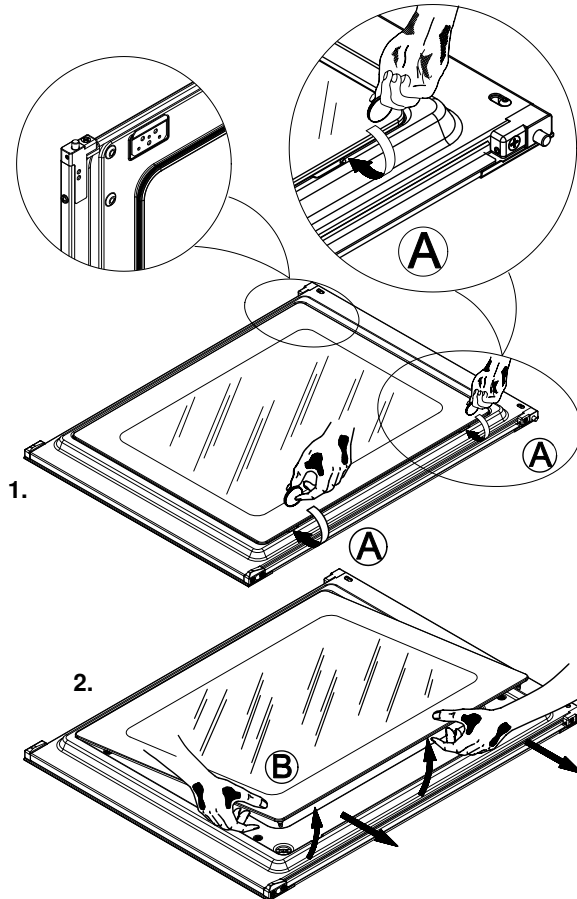

INSTRUCTIONS FOR INSTALLATION

This appliance must be installed by a competent person, in accordance with the current version of the following UK Regulations and Safety Standards or your local Regulations and Safety Standards:

Building Regulations (issued by the Department of Environment)

Building Standards (issued by the Scottish Development Department)

IEE Wiring Regulations

Electricity at Work Regulations

In Australia the installation must comply with AS/NZS3000 wiring rules

PRE-COMMISSIONING THE APPLIANCE

When unpacked, check that the following parts are included with the appliance:

- Sorrento Instruction and Installation Book
- 2 oven shelves
- 1 set comprising Grill Pan, Trivet and handle.
- 4 x Screws and plugs for fixing appliance into housing.

POSITIONING THE APPLIANCE

These appliances are classified as Class 3. All models can be built into a standard 600mm kitchen unit.

INSTALLATION NOTES

1. Ensure that the aperture for oven installation is the correct size.
2. Ensure that the rear panel of the furniture housing has been removed.
3. All ovens with which this instruction book is provided may be installed without the need for any additional ventilation cut-outs.
4. Ensure that the oven has been securely fixed into the housing.

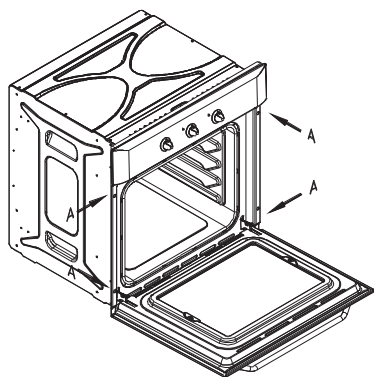

Using the 4 x screws and plastic inserts as provided, insert the plastic inserts into the holes located inside the door cavity and then insert a screw through each insert and tighten until secure.

Fixing the oven on the cabinet

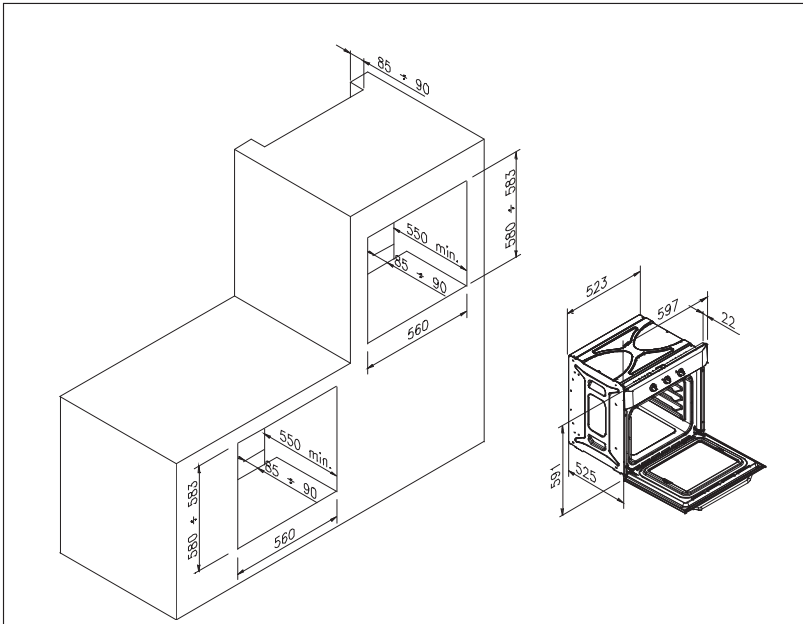

Installation distances for 60cm wide single electric ovens (shape of top casing may vary)

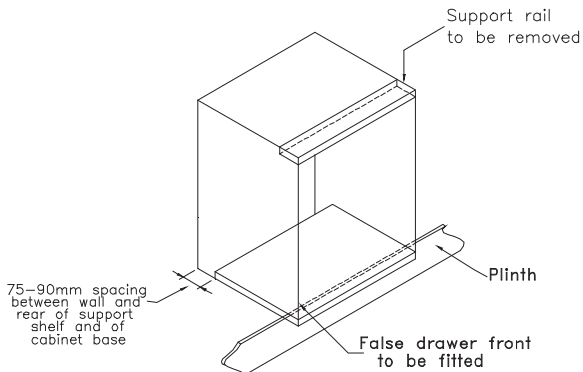

Ventilation and cut-out requirements for installation of a single electric oven into a standard kitchen unit.

Minimum ventilation
Requirements for
rear of unit top, base
and support shelves.

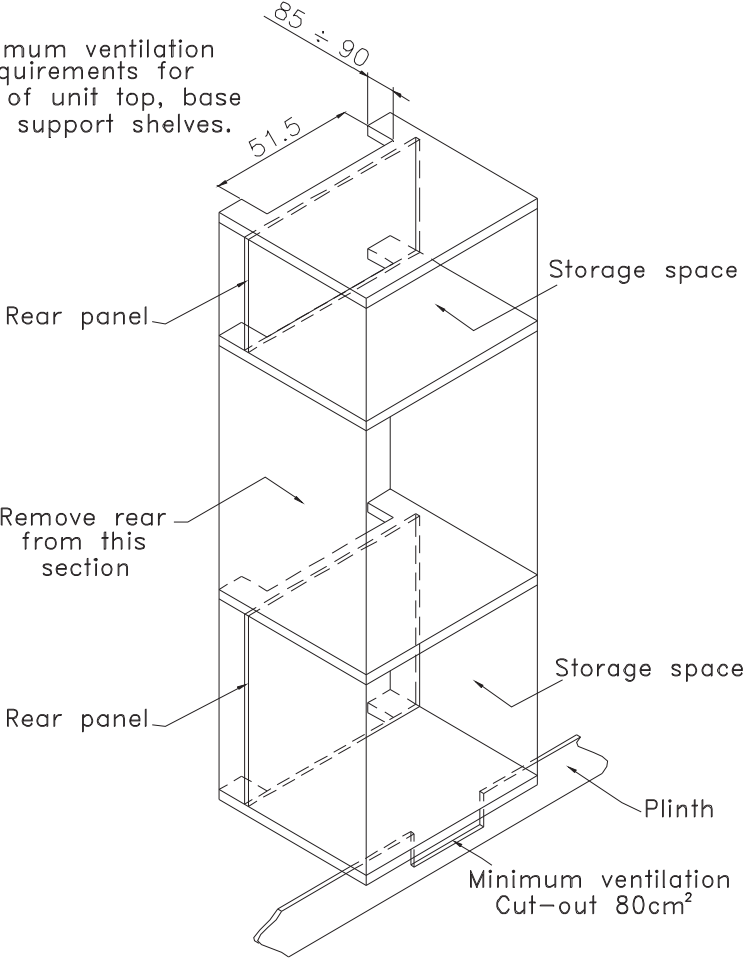

Ventilation and cut-out requirements for installation of a single electric oven into a tall housing unit.

Installation scheme for the models with reversable door - VO6SFS

1.a

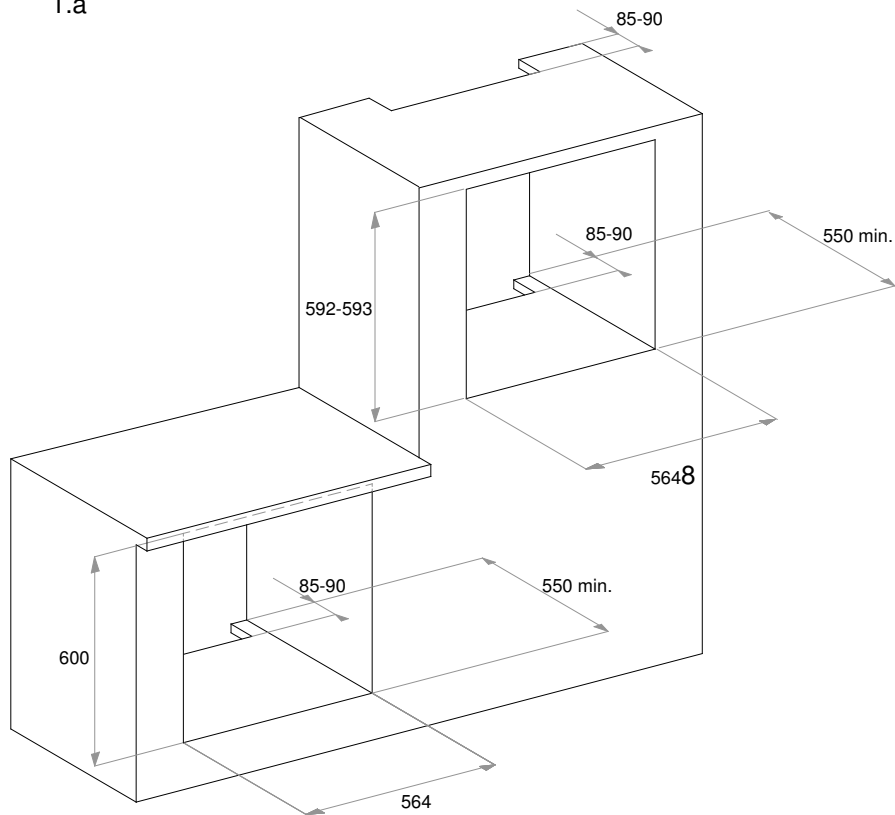

1.b

- 1. fixing screw
- 2. oven door
- 3. front panel

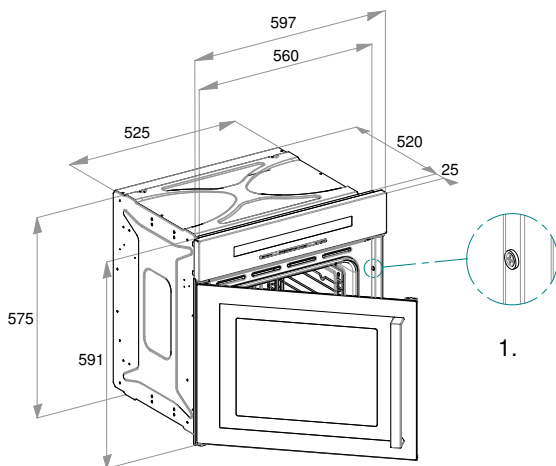
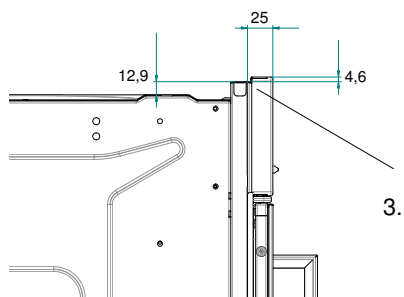
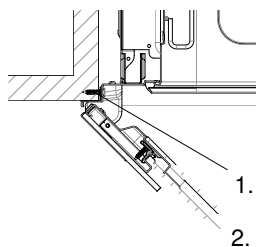

ELECTRICAL CONNECTION

Before connecting the appliance, make sure the supply voltage marked on the Rating Plate corresponds with the mains supply voltage.

WARNING – THIS APPLIANCE MUST BE EARTHED

This appliance should be wired into a 16A double pole switched fused spur outlet having 3mm contact separation and placed in an easily accessible position adjacent to the appliance.

IMPORTANT

The wires in the mains supply lead are coloured in accordance with the following code:

Green and Yellow	-	Earth
Blue	-	Neutral
Brown	-	Live

The wire coloured Green and Yellow must be connected to the terminal marked 'E' or with the earth symbol (\perp) or coloured green and yellow.

The wire coloured Blue must be connected to the terminal marked 'load' and 'N'.

The wire coloured Brown must be connected to the terminal marked 'load' and 'L'.

Care must be taken to ensure that the temperature of the mains supply lead does not exceed 50°C.

REPLACING THE MAINS LEAD

In the event it is necessary to replace the mains supply lead, proceed as follows:

1. Disconnect the appliance from the supply, undo the fixing screws and remove the back panel.
2. Undo the clamp screws and terminal screws to release the existing lead.
3. Assemble the replacement lead that must conform to the specification listed in the Technical Data, ensuring the correct colour code connection and that all screws are tightened correctly.

MAINTENANCE

Before carrying out any maintenance, disconnect the appliance from the electricity supply.

During the guarantee period, in case of need all service interventions should be referred back to the Sorrento Service department. Please note that intervention or repair by any unauthorised personnel will invalidate such guarantee.

REPLACING THE OVEN LIGHT

(Not covered by the appliance warranty)

Disconnect the appliance from the electricity supply, remove the oven door (as described previously) as well as the oven shelves.

Remove the protective glass light-cover by twisting anti-clockwise.

Unscrew the old bulb and discard safely, replace with the type specified in the Technical Data and refit the cover.

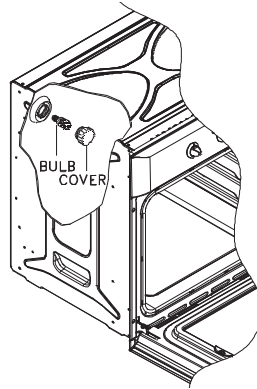

NOTE – The glass cover may be tight and may therefore require a tight grip to release.

CARE AND REPLACEMENT OF CATALYTIC LINERS

(Where fitted / Not covered by the appliance warranty).

To keep the ‘stay clean’ liners operating effectively, the oven should be heated to at least 200°C whenever heavy soiling has occurred, in order to avoid permanent soiling.

If the liners are allowed to become black and shiny, they must be replaced by new items. Remove all internal accessories to facilitate replacement of the liners.

Replacement liners may be purchased directly from the Sorrento Spares Department (details on the following pages).

TECHNICAL DATA

DIMENSIONS

Height:	595mm
Width:	596mm (at front)
Depth:	524mm (excluding handles)

COOLING FAN

A tangential cooling fan is fitted on the following model:
SFFO6, VEO6001, VFFO6SS, VFFO6W, VO6SFS

ELECTRICAL DETAILS

Rated Voltage: 240V~ 50Hz

Supply Connection: 16A
(double pole switched fused outlet with 3mm contact gap)

Max Rated Inputs:
SFFO6, VEO6001, VFFO6SS, VFFO6W, VO6SFS 2.35kW

Mains supply lead: 3x 1.5mm² type H05 RR-F <HAR>

Oven Light Bulb: 25W/300°C Screw type pigmy

